

Socket Cap Screws

Stainless Steel, with Reduced Head Diameter, with Internal Hex

SPECIFICATION

Stainless steel AISI 304 NI

INFORMATION

Socket cap screws GN 912.3 have a reduced head diameter compared with socket cap screws ISO 4762.

Thus the screws can be countersunk in places where this would not be possible with standard socket cap screws due to insufficient space, such as a small edge distance.

Due to their head geometry, screws according to this specification have a reduced load capacity as per ISO 898-1.



TECHNICAL INFORMATION

- Stainless Steel Characteristics (see page A26)

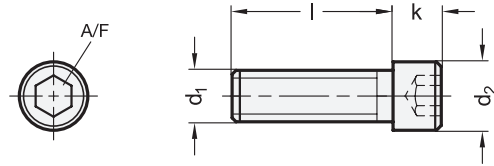

Assembly examples / Comparison

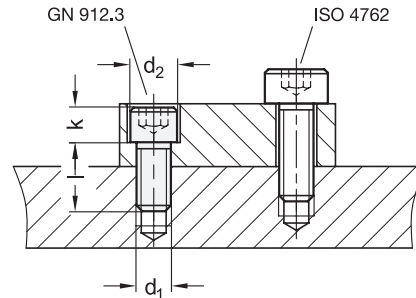

GN 912.3

STAINLESS STEEL

Description	d1	Length l	d2 ±0.1	k	A/F	⚖️
GN 912.3-M3-5-NI	M 3	5	4,5	3	2,5	1
GN 912.3-M3-6-NI	M 3	6	4,5	3	2,5	2
GN 912.3-M3-8-NI	M 3	8	4,5	3	2,5	3
GN 912.3-M3-10-NI	M 3	10	4,5	3	2,5	4
GN 912.3-M3-12-NI	M 3	12	4,5	3	2,5	5
GN 912.3-M4-6-NI	M 4	6	5,5	4	3	1
GN 912.3-M4-8-NI	M 4	8	5,5	4	3	2
GN 912.3-M4-10-NI	M 4	10	5,5	4	3	3
GN 912.3-M4-12-NI	M 4	12	5,5	4	3	4
GN 912.3-M4-16-NI	M 4	16	5,5	4	3	5
GN 912.3-M4-20-NI	M 4	20	5,5	4	3	6
GN 912.3-M4-25-NI	M 4	25	5,5	4	3	7
GN 912.3-M5-8-NI	M 5	8	7	4,5	4	2
GN 912.3-M5-10-NI	M 5	10	7	4,5	4	3
GN 912.3-M5-12-NI	M 5	12	7	4,5	4	4
GN 912.3-M5-16-NI	M 5	16	7	4,5	4	5
GN 912.3-M5-20-NI	M 5	20	7	4,5	4	6
GN 912.3-M5-25-NI	M 5	25	7	4,5	4	7
GN 912.3-M6-8-NI	M 6	8	8,5	5,5	5	3
GN 912.3-M6-10-NI	M 6	10	8,5	5,5	5	4
GN 912.3-M6-12-NI	M 6	12	8,5	5,5	5	5
GN 912.3-M6-16-NI	M 6	16	8,5	5,5	5	6
GN 912.3-M6-20-NI	M 6	20	8,5	5,5	5	7
GN 912.3-M6-25-NI	M 6	25	8,5	5,5	5	8
GN 912.3-M6-30-NI	M 6	30	8,5	5,5	5	9

Description	d1	Length l	d2 ±0.1	k	A/F	⚖️
GN 912.3-M8-10-NI	M 8	10	11	7,5	6	8
GN 912.3-M8-12-NI	M 8	12	11	7,5	6	9
GN 912.3-M8-16-NI	M 8	16	11	7,5	6	10
GN 912.3-M8-20-NI	M 8	20	11	7,5	6	11
GN 912.3-M8-25-NI	M 8	25	11	7,5	6	12
GN 912.3-M8-30-NI	M 8	30	11	7,5	6	14
GN 912.3-M8-35-NI	M 8	35	11	7,5	6	16
GN 912.3-M10-16-NI	M 10	16	13,5	9,5	8	16
GN 912.3-M10-20-NI	M 10	20	13,5	9,5	8	18
GN 912.3-M10-25-NI	M 10	25	13,5	9,5	8	20
GN 912.3-M10-30-NI	M 10	30	13,5	9,5	8	23
GN 912.3-M10-35-NI	M 10	35	13,5	9,5	8	26
GN 912.3-M10-40-NI	M 10	40	13,5	9,5	8	28